

AWS 110

heavy duty industrial low profile platform scale

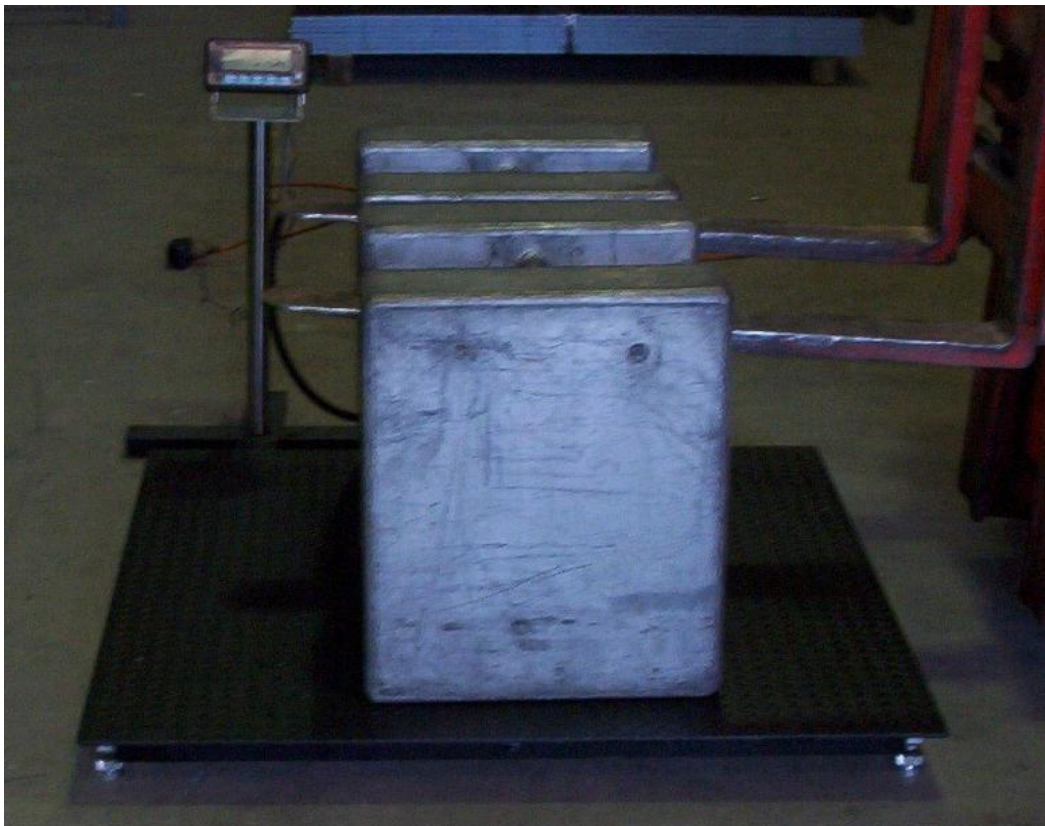
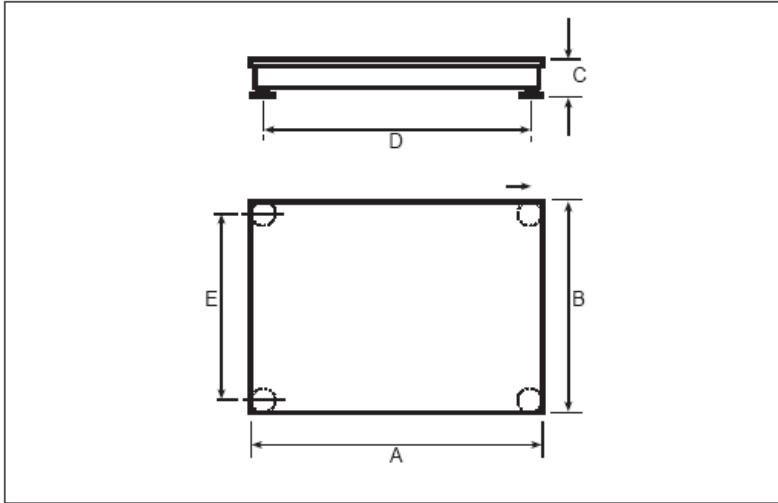

Description: The AWS110 is typically a surface mount pallet size platform scale fabricated from mild steel, with option of stainless construction (POA). The rugged scale incorporates four (4) approved precision shear beam load cells available in varies capacities to 15 tonnes. Stainless steel load cells available as an option. The load cells are run to a junction box concealed under the platform and terminated into a summing board to accurately tune each corner to provide accurate weighing over the entire surface. Many brands of indicator are available for connection to the AWS 110, or your existing indicator is more than likely compatible.

- The AWS 110 is National Standards Approved No: 6/9C/275 for trade use in Australia.
- Extra work has gone into designing a very durable ball motion stainless steel foot assembles for each load cell. This improves the accuracy of the platform scale and reduces damage cause by forklifts and other loading devices.
- The standard unit is designed for capacities up to 4000 kg, other capacities and sizes can be fabricated to order.

Dimensions:

Platform Size A x B	C	D	E	Approx Weight
1000 x 1000 mm	100 mm	877 mm	1130 mm	145 kg
1200 x 1200 mm	100 mm	1127 mm	1130 mm	170 kg
1200 x 1500 mm	100 mm	1127 mm	1380 mm	200 kg
1800 x 1200 mm	100 mm	TBA	TBA	245 kg
Customer Specified	Load of Choice	To 15 T Certified	Available	

Options:

1. Stainless steel platform surface is plain, not floor plate.
2. Loading Ramp, can attached the platform scale for secure fit. Base can support two (2) ramps per AWS 110 base.
3. Larger capacity and other brands of load cells supported on request, price on application.
4. Ten (10) metre base work to digital indicator interconnecting cable.
5. Hot dip galvanized finished AWS 110 steel structure.

Finish: Steelwork painted two (2) coats of enamel paint. Junction box die cast aluminum with enamel finish.

Approvals: National Standards Commission Class III Approval: 6/9C/275.

Environment: Industrial or other. Nominal operating temperature -10degC to 40degC Storage temperature -10degC to 60degC Resistant to dirt & moisture.

Your Local Distributor:



Unit 9 /160 Hartley Road,
Smeaton Grange NSW 2567
Ph: 1300 366 131 Fax: 02 4454 4099
Email: sales@awsscales.com.au